

0.75~5.5kW 2P

50Hz : 2850rpm

60Hz : 3450rpm

**Specification**

- Insulation class : F
- Protection class : IP68
- Water temperature : up to 40°C
- PH : 6 to 10
- Density of liquid : 1.3g/cm³
- Power supply :
  - three phase 380V ±10%, 50Hz
  - three phase 380V ±10%, 60Hz
  - single phase 220V ±10%, 50Hz
  - single phase 220V ±10%, 60Hz
- Motor protection : built in
- Capacity : up to 25m³/h
- Head : up to 42m
- Maximum immersion depth : 10m
- Cable length : 8m



**GRINDING CAPACITY OF G PUMPS**

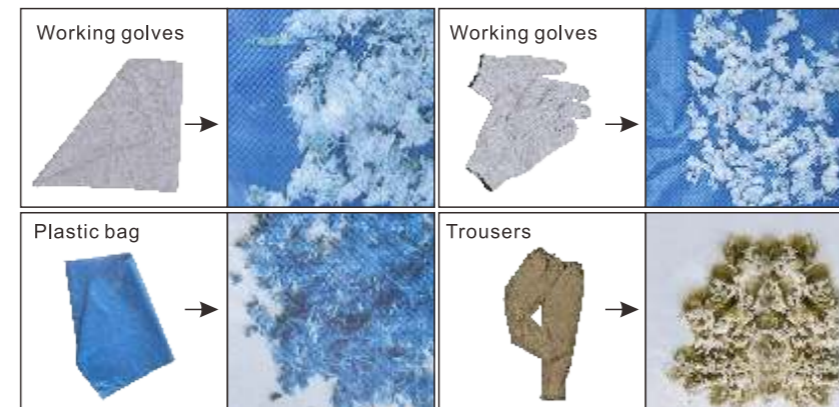

**Materials of construction**

| Item No. | Part name           | Material               |
|----------|---------------------|------------------------|
| 01       | Hose coupling       | Cast iron              |
| 01a      | Hose coupling       | Cast iron              |
| 03       | Terminal box        | Cast iron              |
| 05       | Upper cover         | Cast iron              |
| 07       | Bearing house       | Cast iron              |
| 10       | Seal bracket        | Cast iron              |
| 11       | Motor body          | Cast iron              |
| 13       | Pump body           | Cast iron              |
| 14a      | Impeller            | Ductile iron           |
| 14b      | Rotational blade    | High chrome alloy      |
| 16       | Stationary Blade    | High chrome alloy      |
| 17       | Coupling adapter    | Cast iron              |
| 22       | Seat assembly       | Cast iron              |
| 22a      | Coupling seat       | Cast iron              |
| 22b      | Upper guide support | Cast iron              |
| 27       | Stator              |                        |
| 28       | Rotor               | Shaft : AISI304SS      |
| 30       | Flange              | Cast iron              |
| 31a      | Bearing             | Ball bearing           |
| 31b      | Bearing             | Ball bearing           |
| 33       | Motor protector     |                        |
| 34       | Mechanical seal     | Sic-Sic/Carbon-Ceramic |
| 35       | Oil seal            |                        |
| 47       | Cable               |                        |

**Movable Soft Pipe Installation (R)**

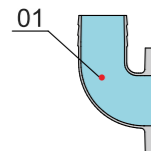

**Movable Hard Pipe Installation (Y)**

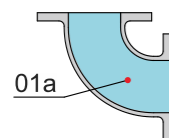

**Auto-coupled Installation (Z)**

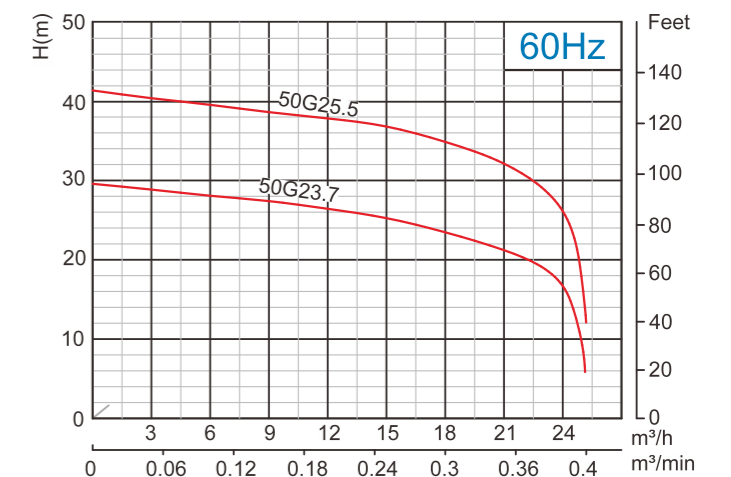
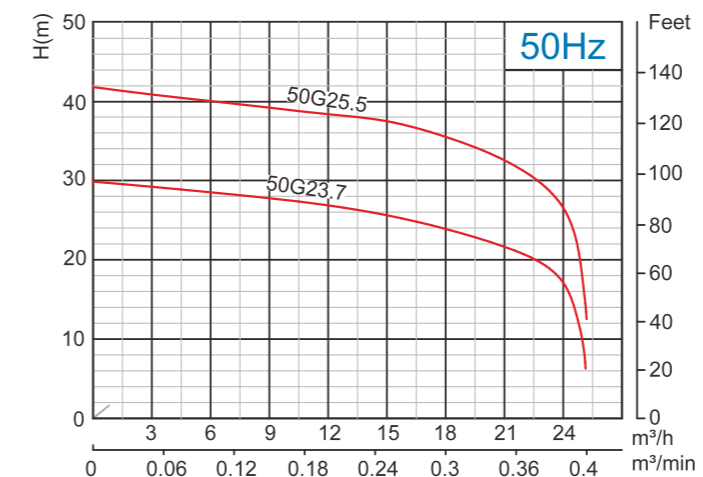
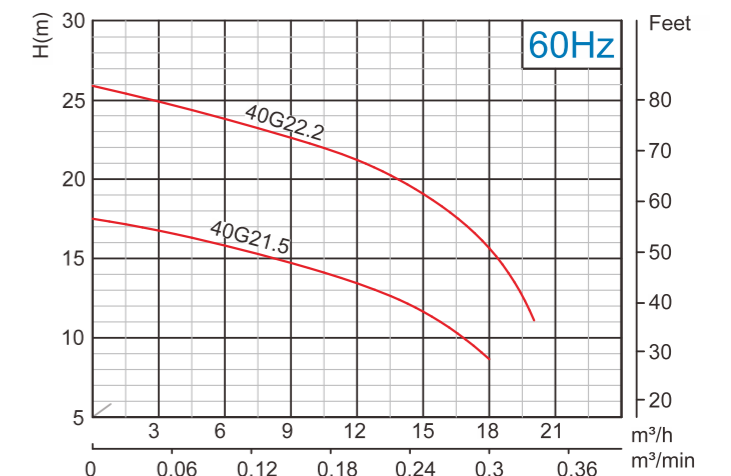
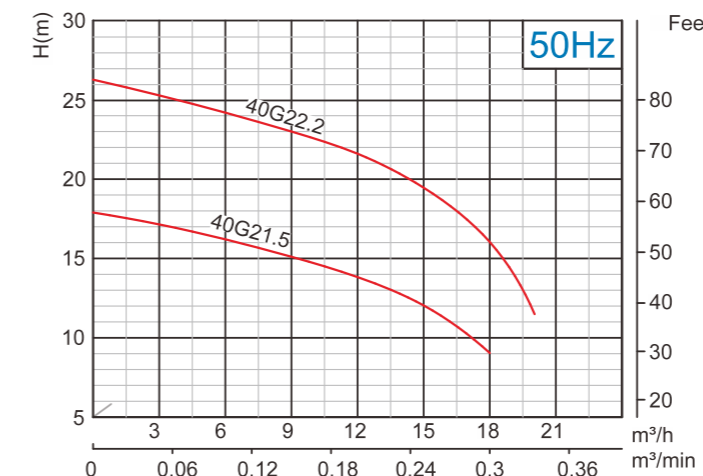
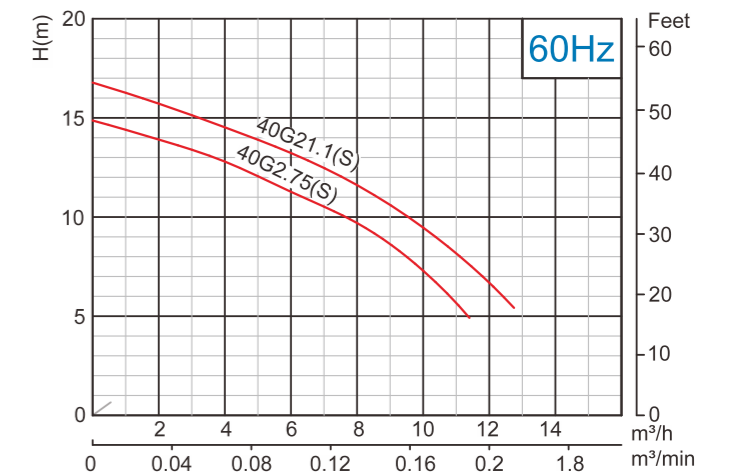
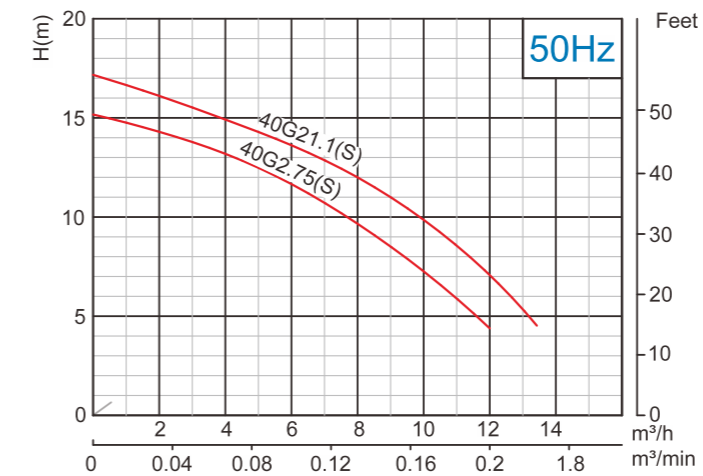
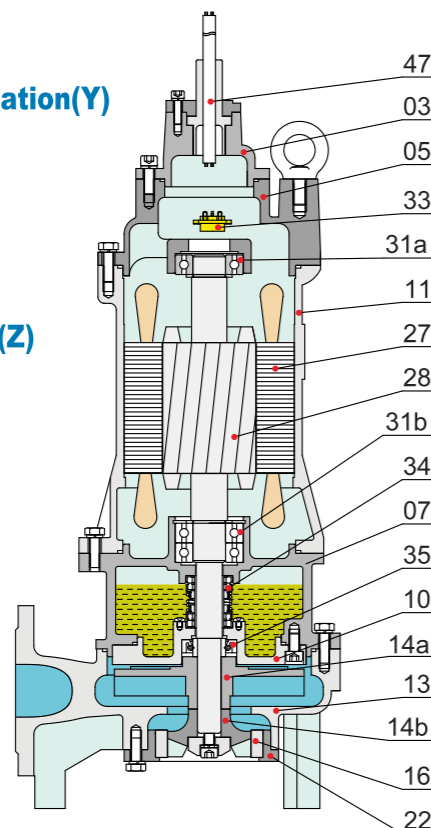
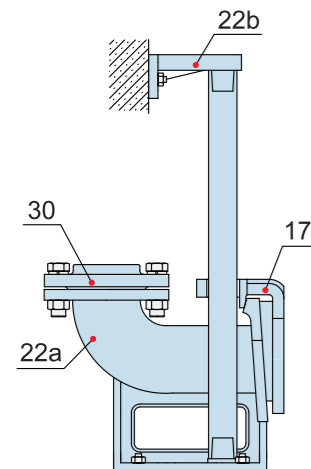

| Model    | Voltage | Current | Motor power |     | Outlet |    | Rated capacity | Rated head | Max capacity | Max Head | Cable |
|----------|---------|---------|-------------|-----|--------|----|----------------|------------|--------------|----------|-------|
|          |         |         | kW          | HP  | in     | mm |                |            |              |          |       |
| 40G2.75  | 380     | 2       | 0.75        | 1   | 1½     | 40 | 8              | 10         | 12           | 15       | 4G1.0 |
| 40G2.75S | 220     | 5.2     | 0.75        | 1   | 1½     | 40 | 8              | 10         | 12           | 15       | 3G1.0 |
| 40G21.1  | 380     | 2.8     | 1.1         | 1.5 | 1½     | 40 | 8              | 12         | 13           | 17       | 4G1.0 |
| 40G21.1S | 220     | 7.2     | 1.1         | 1.5 | 1½     | 40 | 8              | 12         | 13           | 17       | 3G1.0 |
| 40G21.5  | 380     | 3.2     | 1.5         | 2   | 1½     | 40 | 10             | 14         | 18           | 18       | 4G1.0 |
| 40G22.2  | 380     | 5       | 2.2         | 3   | 1½     | 40 | 10             | 22         | 20           | 26       | 4G1.0 |
| 50G23.7  | 380     | 8.5     | 3.7         | 5   | 2      | 50 | 15             | 25         | 25           | 30       | 4G1.5 |
| 50G25.5  | 380     | 11.7    | 5.5         | 7.5 | 2      | 50 | 15             | 38         | 25           | 42       | 4G2.5 |

**Movable Soft Pipe Installation (R)**

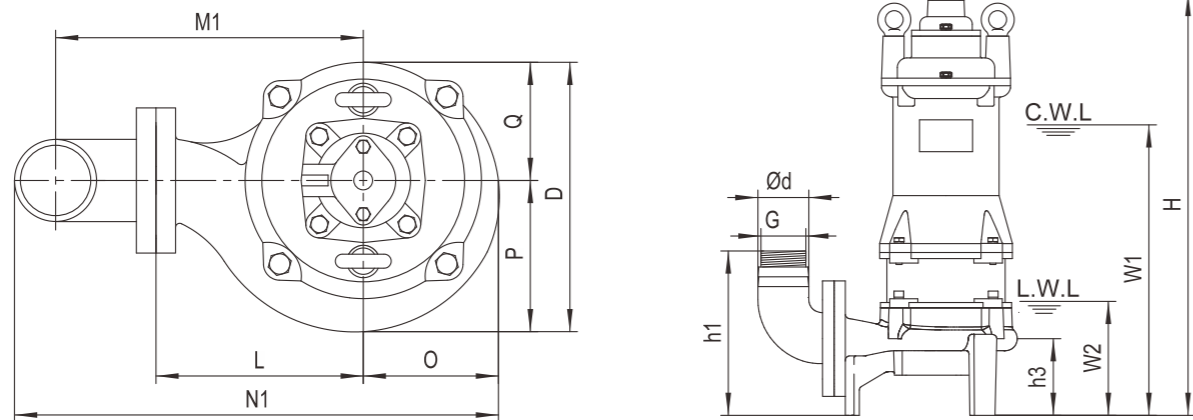

**Movable Hard Pipe Installation(Y)**

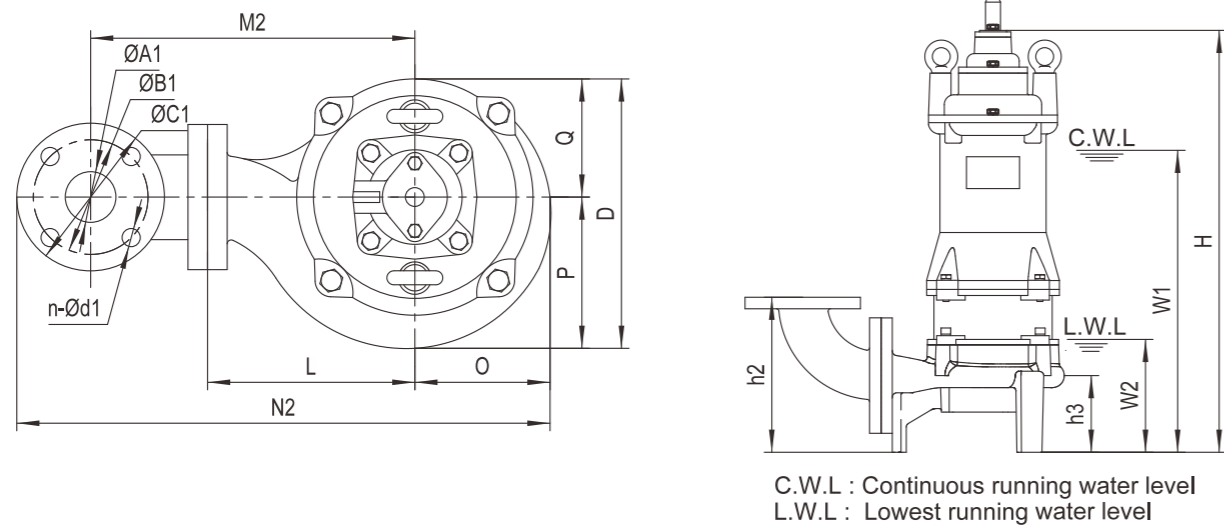

**Dimensions table**

| Model    | Ød | G    | ØA1 | ØB1 | ØC1 | n-Ød1 | h1  | h2  | h3  | W1  | W2  | H   | O   | P   | Q   | L   | D   | M1  | M2  | N1  | N2  |
|----------|----|------|-----|-----|-----|-------|-----|-----|-----|-----|-----|-----|-----|-----|-----|-----|-----|-----|-----|-----|-----|
| 40G2.75  | 40 | —    | 40  | 100 | 130 | 4-Ø14 | 165 | 185 | 85  | 320 | 125 | 475 | 82  | 85  | 80  | 130 | 165 | 193 | 232 | 295 | 380 |
| 40G2.75S | 40 | —    | 40  | 100 | 130 | 4-Ø14 | 165 | 185 | 85  | 335 | 125 | 475 | 82  | 85  | 80  | 130 | 165 | 193 | 232 | 295 | 380 |
| 40G21.1  | 40 | —    | 40  | 100 | 130 | 4-Ø14 | 165 | 185 | 85  | 335 | 125 | 475 | 82  | 85  | 80  | 130 | 165 | 193 | 232 | 295 | 380 |
| 40G21.1S | 40 | —    | 40  | 100 | 130 | 4-Ø14 | 165 | 185 | 85  | 355 | 125 | 495 | 82  | 85  | 80  | 130 | 165 | 193 | 232 | 295 | 380 |
| 40G21.5  | 40 | —    | 40  | 100 | 130 | 4-Ø14 | 170 | 190 | 90  | 355 | 125 | 525 | 95  | 100 | 100 | 150 | 200 | 210 | 250 | 325 | 410 |
| 40G22.2  | 40 | —    | 40  | 100 | 130 | 4-Ø14 | 170 | 190 | 90  | 375 | 125 | 545 | 95  | 100 | 100 | 150 | 200 | 210 | 250 | 325 | 410 |
| 50G23.7  | 50 | G1½" | 50  | 110 | 140 | 4-Ø14 | 205 | 200 | 100 | 405 | 125 | 610 | 100 | 105 | 100 | 155 | 205 | 220 | 250 | 345 | 420 |
| 50G25.5  | 50 | G1½" | 50  | 110 | 140 | 4-Ø14 | 200 | 195 | 95  | 440 | 125 | 635 | 110 | 115 | 105 | 160 | 220 | 225 | 255 | 360 | 435 |

**Weights & Packing dimensions**

| Model    | R    |      |                   | Y    |      |                   |
|----------|------|------|-------------------|------|------|-------------------|
|          | N.W  | G.W  | Packing dimension | N.W  | G.W  | Packing dimension |
|          | kg   | kg   | mm                | kg   | kg   | mm                |
| 40G2.75  | 25   | 26.5 | 515×235×220       | 27   | 28.5 | 515×235×230       |
| 40G2.75S | 26   | 27.5 | 515×235×220       | 28   | 29.5 | 515×235×230       |
| 40G21.1  | 26.5 | 28   | 535×235×220       | 28.5 | 30   | 535×235×230       |
| 40G21.1S | 27.5 | 29   | 535×235×220       | 29.5 | 31   | 535×235×230       |

| Model   | R    |      |                   | Y    |      |                   |
|---------|------|------|-------------------|------|------|-------------------|
|         | N.W  | G.W  | Packing dimension | N.W  | G.W  | Packing dimension |
|         | kg   | kg   | mm                | kg   | kg   | mm                |
| 40G21.5 | 37.5 | 41   | 630×240×285       | 39.5 | 43   | 630×240×295       |
| 40G22.2 | 40.5 | 43.5 | 630×240×285       | 42.5 | 45.5 | 630×240×295       |
| 50G23.7 | 54   | 60   | 720×260×305       | 56   | 62   | 720×260×315       |
| 50G25.5 | 67   | 73   | 750×280×315       | 69   | 75   | 750×280×325       |

**Auto-Coupled Installation (Z)**

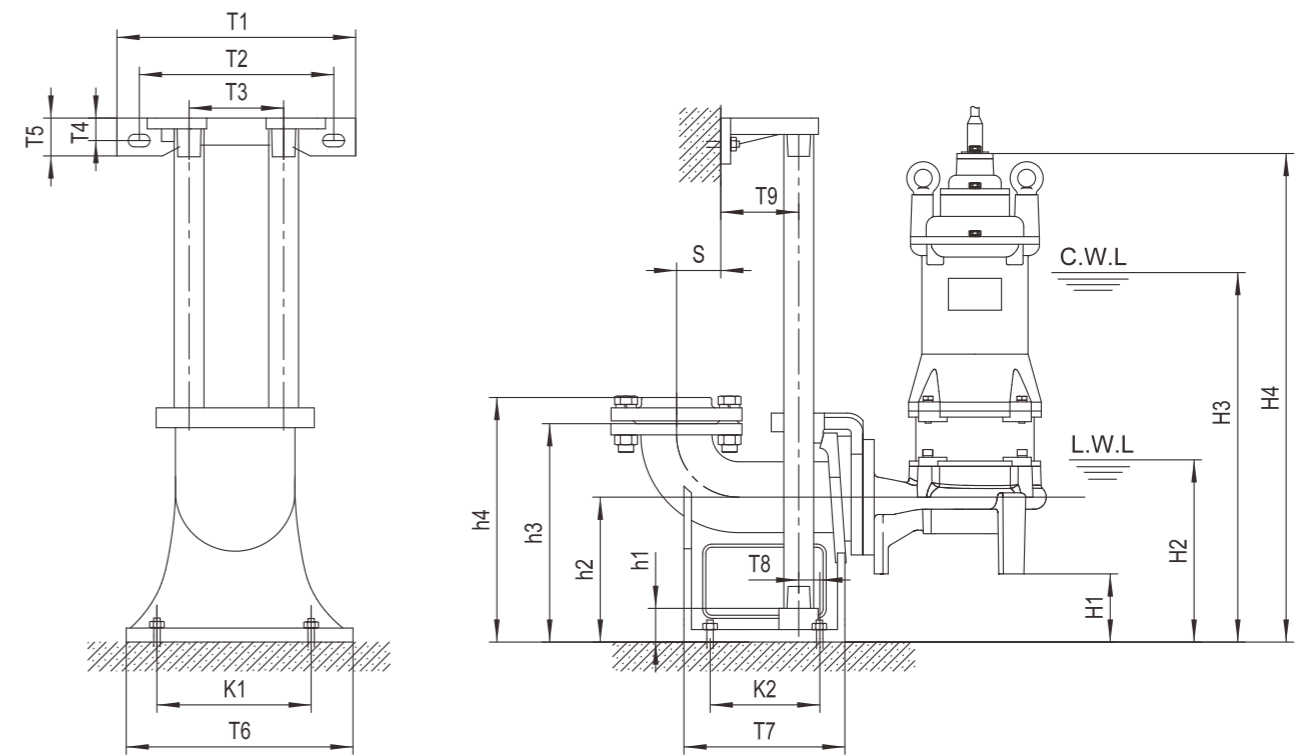

C.W.L : Continuous running water level  
L.W.L : Lowest running water level

The coupling and pump will be packed individually, packing dimension and weight in table only refer to the pump, please refer to P48 to check coupling's packing dimension and weight.

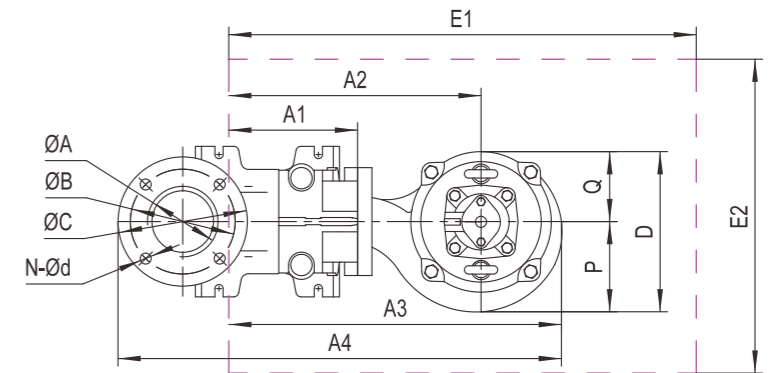

**Dimensions table**

| Auto coupling | ØA         | ØB  | ØC  | N-Ød  | T1  | T2  | T3  | T4 | T5 | T6  | T7  | T8 | T9 | K1  | K2  | S  | h1  | h2  | h3  | h4  |
|---------------|------------|-----|-----|-------|-----|-----|-----|----|----|-----|-----|----|----|-----|-----|----|-----|-----|-----|-----|
| 40-40(PN6)    | Ø40 / G1½" | 100 | 130 | 4-Ø14 | 225 | 185 | 70  | 18 | 35 | 110 | 140 | 5  | 65 | 65  | 70  | 60 | 150 | 115 | 195 | 215 |
| 50-50(PN6)    | Ø50 / G2"  | 110 | 140 | 4-Ø14 | 265 | 215 | 105 | 25 | 42 | 200 | 215 | 15 | 67 | 165 | 135 | 63 | 25  | 160 | 250 | 280 |

**Dimensions table**

| Model    | Auto coupling | H1 | H2  | H3  | H4  | A1  | A2  | A3  | A4  | P   | Q   | D   | E1×E2   | Pump weight & packing dimension |      |                   |
|----------|---------------|----|-----|-----|-----|-----|-----|-----|-----|-----|-----|-----|---------|---------------------------------|------|-------------------|
|          |               |    |     |     |     |     |     |     |     |     |     |     |         | N.W                             | G.W  | Packing dimension |
| 40G2.75  | 40-40(PN6)    | 32 | 160 | 355 | 510 | 145 | 275 | 360 | 485 | 85  | 80  | 165 | 650×550 | 23                              | 24.5 | 515×235×220       |
| 40G2.75S | 40-40(PN6)    | 32 | 160 | 370 | 510 | 145 | 275 | 360 | 485 | 85  | 80  | 165 | 650×550 | 24                              | 25.5 | 515×235×220       |
| 40G21.1  | 40-40(PN6)    | 32 | 160 | 370 | 510 | 145 | 275 | 360 | 485 | 85  | 80  | 165 | 650×550 | 24.5                            | 26   | 535×235×220       |
| 40G21.1S | 40-40(PN6)    | 32 | 160 | 390 | 530 | 145 | 275 | 360 | 485 | 85  | 80  | 165 | 650×550 | 25.5                            | 27   | 535×235×220       |
| 40G21.5  | 40-40(PN6)    | 25 | 155 | 385 | 555 | 145 | 295 | 390 | 515 | 100 | 100 | 200 | 650×550 | 35.5                            | 39   | 630×240×285       |
| 40G22.2  | 40-40(PN6)    | 25 | 155 | 405 | 575 | 145 | 295 | 390 | 515 | 100 | 100 | 200 | 650×550 | 38.5                            | 41.5 | 630×240×285       |
| 50G23.7  | 50-50(PN6)    | 60 | 185 | 465 | 670 | 155 | 310 | 410 | 540 | 105 | 100 | 205 | 650×550 | 52                              | 58   | 720×260×305       |
| 50G25.5  | 50-50(PN6)    | 65 | 195 | 505 | 700 | 155 | 310 | 420 | 550 | 115 | 105 | 220 | 650×550 | 65                              | 71   | 750×280×315       |